

Face Seal Fittings

FR Series Face Seal Fittings

Features

- ⦿ Metal-to-metal seal to provide perfect leak-tight service for working conditions from critical vacuum to high pressure
- ⦿ Precision manufactured gasket to ensure best performance
- ⦿ Test port at nut for easy leak testing
- ⦿ Silver-plated female threads
- ⦿ Standard surface roughness finished to an average of Ra 10 μm . (0.25 μm) or electropolished to Ra 5 μm . (0.13 μm) optional
- ⦿ All seal faces and male threads protected with plastic caps
- ⦿ Every gland and body marked with size, material and heat code



Technical Data

- ⦿ Sizes range from 1/16" to 1" and 6 mm to 18 mm
- ⦿ Thread Specifications:

Thread Type	Specification
NPT	ASME B1.20.1, SAE AS71051
Unified (SAE)	ASME B1.1, SAE J475

- ⦿ Materials:

Material	Bar Stock	Forging	Designator
Fitting Material			
316 SS	ASTM A276	ASME SA182	SS
316L SS	ASME SA479	ASTM A314	6L
316L VAR SS	SEMI F20		6LV
Gasket Material			
316L SS	ASTM A240		6L
Copper	ASTM B152		CU
Nickel	ASTM B162		NI

- ⦿ Working Pressure:
Working pressures shown in the Catalog are calculated according to ASME B31.3 and B31.1 at ambient temperature.

- ⦿ Working Temperature:

Component	Material	Max. Temperature
Fittings	316 SS	1000°F (538°C)
	316L SS	
	316L VAR SS	
Gaskets	316L SS	400°F (204°C)
	Copper	
	Nickel	

Testing

Every FR fitting is Helium leak tested to a maximum allowable leak rate of 4×10^{-9} std cm³/s.

Ordering Information

- ⦿ Each component can be ordered separately.
- ⦿ Add the material designator as a prefix, cleaning and packaging code as a suffix to the basic ordering number to get the complete ordering number.
- ⦿ Cleaning and Packaging
 - a. FC-01 Standard Cleaning and Packaging for general industrial procedures. No suffix is needed.
 - b. FC-02 Special Cleaning and Packaging, to ensure compliance with product cleanliness requirement as stated in ASTM G93 Level C. Add "-F2" as a suffix when needed.
 - c. FC-03 Ultra-High Purity Process Specification is applied to products with wetted surface roughness finished to an average of Ra 5 μin. (0.13 μm). Add "-F3" as suffix when needed. It is only available for 316L and 316L VAR SS fittings.

Example: For 1/2" 316L VAR SS gland with FC-03 Ultra-High Purity Process Specification, the complete ordering number is 6LV-G-FR8-TB8-6-F3.

Installation Instructions

1. Assemble the gland, nut, gasket and male nut as below. Finger tight the nut.

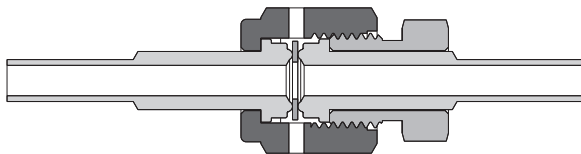

2. For fittings with 316L SS and Nickel gaskets, tighten the nut 1/8 turn with a wrench while holding the male nut or the fitting body steady. Tighten the nut 1/4 turn for those with Copper gaskets.

Cautions

- ⦿ Dimensions are for reference only and are subject to change.
- ⦿ Over-tightening will damage the sealing beads and lead to possible leak.
- ⦿ Utilize a new gasket for each assembly.
- ⦿ Tungsten Inert Gas Welding (TIG) is recommended.
- ⦿ Always apply proper thread sealants on tapered pipe threads.
- ⦿ Do not loosen or tighten fittings when system is pressurized.

Glands

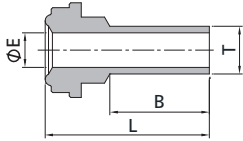

FR Gland to Short Fractional Tube Butt Weld									
FR Size (in.)	T-Tube O.D. (in.)	Nominal Wall Thickness (in.)	Basic Ordering Number	Dimensions, in. (mm)			Working Pressure, psig (bar)		
				L	B	E	6L	CU	NI
1/8	1/8	0.028	-G-FR2-TB2-12S	1.08 (27.4)	0.75 (19.1)	0.06 (1.5)	8500 (586)	6800 (468)	8500 (586)
1/4	1/8	0.028	-G-FR4-TB2-12S	1.10 (27.9)	0.75 (19.1)	0.06 (1.5)	5100 (351)	5100 (351)	5100 (351)
1/4	1/4	0.035	-G-FR4-TB4-4S	0.60 (15.2)	0.25 (6.4)	0.18 (4.6)	5100 (351)	5100 (351)	5100 (351)
1/4	1/4	0.035	-G-FR4-TB4-6S	0.72 (18.3)	0.38 (9.6)	0.18 (4.6)	5100 (351)	5100 (351)	5100 (351)
1/4	1/4	0.035	-G-FR4-TB4-12S	1.10 (27.9)	0.75 (19.1)	0.18 (4.6)	5100 (351)	5100 (351)	5100 (351)
1/2	1/4	0.035	-G-FR8-TB4-12S	1.12 (28.4)	0.75 (19.1)	0.18 (4.6)	4300 (296)	2800 (192)	3500 (241)
1/2	3/8	0.035	-G-FR8-TB6-4S	0.62 (15.7)	0.25 (6.4)	0.31 (7.9)	3300 (227)	2600 (179)	3300 (227)
1/2	3/8	0.035	-G-FR8-TB6-12S	1.12 (28.4)	0.75 (19.1)	0.31 (7.9)	3300 (227)	2600 (179)	3300 (227)
1/2	1/2	0.049	-G-FR8-TB8-4S	0.62 (15.7)	0.25 (6.4)	0.40 (10.2)	3500 (241)	2800 (192)	3500 (241)
1/2	1/2	0.049	-G-FR8-TB8-6S	0.74 (18.8)	0.38 (9.6)	0.40 (10.2)	3500 (241)	2800 (192)	3500 (241)
1/2	1/2	0.049	-G-FR8-TB8-12S	1.12 (28.4)	0.75 (19.1)	0.40 (10.2)	3500 (241)	2800 (192)	3500 (241)

FR Gland to Short Metric Tube Butt Weld									
FR Size (in.)	T-Tube O.D. (mm)	Nominal Wall Thickness (mm)	Basic Ordering Number	Dimensions, mm (in.)			Working Pressure, bar (psig)		
				L	B	E	6L	CU	NI
1/4	6	1.0	-G-FR4-MTB6-12S	29.5 (1.16)	19.1 (0.75)	4.0 (0.16)	468 (6800)	372 (5400)	468 (6800)
1/4	8	1.0	-G-FR4-MTB8-12S	29.5 (1.16)	19.1 (0.75)	6.0 (0.24)	337 (4900)	337 (4900)	337 (4900)
1/2	10	1.0	-G-FR8-MTB10-12S	29.5 (1.16)	19.1 (0.75)	8.0 (0.31)	241 (3500)	192 (2800)	241 (3500)
1/2	12	1.0	-G-FR8-MTB12-12S	29.5 (1.16)	19.1 (0.75)	10.0 (0.39)	213 (3100)	165 (2400)	213 (3100)
3/4	18	1.5	-G-FR12-MTB18-12S	31.0 (1.22)	19.1 (0.75)	15.0 (0.59)	206 (3000)	165 (2400)	206 (3000)

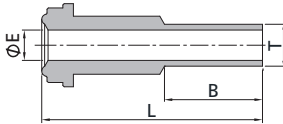

FR Gland to Long Fractional Tube Butt Weld									
FR Size (in.)	T-Tube O.D. (in.)	Nominal Wall Thickness (in.)	Basic Ordering Number	Dimensions, in. (mm)			Working Pressure, psig (bar)		
				L	B	E	6L	CU	NI
1/8	1/8	0.028	-G-FR2-TB2-12	1.42 (36.1)	0.75 (19.1)	0.06 (1.5)	8500 (586)	6800 (468)	8500 (586)
1/4	1/4	0.035	-G-FR4-TB4-4	1.20 (30.5)	0.25 (6.4)	0.18 (4.6)	5100 (351)	5100 (351)	5100 (351)
1/4	1/4	0.035	-G-FR4-TB4-1.31 ^①	1.31 (33.3)	0.36 (9.1)	0.18 (4.6)	5100 (351)	5100 (351)	5100 (351)
1/4	1/4	0.035	-G-FR4-TB4-6	1.32 (33.5)	0.38 (9.6)	0.18 (4.6)	5100 (351)	5100 (351)	5100 (351)
1/4	1/4	0.035	-G-FR4-TB4-12	1.70 (43.2)	0.75 (19.1)	0.18 (4.6)	5100 (351)	5100 (351)	5100 (351)
1/2	1/4	0.035	-G-FR8-TB4-12	1.80 (45.7)	0.75 (19.1)	0.18 (4.6)	4300 (296)	2800 (192)	3500 (241)
1/2	3/8	0.035	-G-FR8-TB6-4	1.29 (32.8)	0.25 (6.4)	0.31 (7.9)	3300 (227)	2600 (179)	3300 (227)
1/2	3/8	0.035	-G-FR8-TB6-12	1.79 (45.5)	0.75 (19.1)	0.31 (7.9)	3300 (227)	2600 (179)	3300 (227)
1/2	1/2	0.049	-G-FR8-TB8-4	1.29 (32.8)	0.25 (6.4)	0.40 (10.2)	3500 (241)	2800 (192)	3500 (241)
1/2	1/2	0.049	-G-FR8-TB8-6	1.41 (35.8)	0.38 (9.6)	0.40 (10.2)	3500 (241)	2800 (192)	3500 (241)
1/2	1/2	0.049	-G-FR8-TB8-12	1.79 (45.5)	0.75 (19.1)	0.40 (10.2)	3500 (241)	2800 (192)	3500 (241)
3/4	3/4	0.049	-G-FR12-TB12-12	2.03 (51.6)	0.75 (19.1)	0.65 (16.5)	2400 (165)	1900 (130)	2400 (165)
1	1	0.065	-G-FR16-TB16-12	2.32 (58.9)	0.75 (19.1)	0.87 (22.1)	2400 (165)	1900 (130)	2400 (165)

FR Gland to Long Metric Tube Butt Weld									
FR Size (in.)	T-Tube O.D. (mm)	Nominal Wall Thickness (mm)	Basic Ordering Number	Dimensions, mm (in.)			Working Pressure, bar (psig)		
				L	B	E	6L	CU	NI
1/4	6	1.0	-G-FR4-MTB6-12	43.2 (1.7)	19.1 (0.75)	4.0 (0.16)	468 (6800)	372 (5400)	468 (6800)
1/4	8	1.0	-G-FR4-MTB8-12	43.2 (1.7)	19.1 (0.75)	6.0 (0.24)	337 (4900)	337 (4900)	337 (4900)
1/2	10	1.0	-G-FR8-MTB10-12	45.5 (1.79)	19.1 (0.75)	8.0 (0.31)	241 (3500)	192 (2800)	241 (3500)
1/2	12	1.0	-G-FR8-MTB12-12	45.5 (1.79)	19.1 (0.75)	10.0 (0.39)	213 (3100)	165 (2400)	213 (3100)
3/4	18	1.5	-G-FR12-MTB18-12	51.6 (2.03)	19.1 (0.75)	15.0 (0.59)	206 (3000)	165 (2400)	206 (3000)

Suffix -4, -6, -12 indicates that Dimension B equals to the specific suffix value times 1/16. Example: With suffix "12", Dimension B= 12/16 = 3/4" or 19.1 mm.
 ① -1.31 means the length of Dim L.

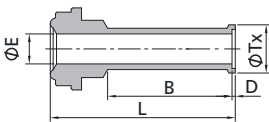

FR Gland to Short Fractional Automatic Tube Butt Weld											
FR Size (in.)	Tube O.D. (in.)	Nominal Wall Thickness (in.)	Basic Ordering Number	Dimensions, in. (mm)					Working Pressure, psig (bar)		
				L	B	D	E	Tx	6L	CU	NI
1/4	1/4	0.035	-AG-FR4-TB4-12S	1.12 (28.4)	0.75 (19.1)	0.02 (0.5)	0.18 (4.6)	0.29 (7.4)	5100 (351)	5100 (351)	5100 (351)
1/2	3/8	0.035	-AG-FR8-TB6-12S	1.15 (29.2)	0.75 (19.1)	0.03 (0.8)	0.31 (7.9)	0.41 (10.4)	3300 (227)	2600 (179)	3300 (227)
1/2	1/2	0.049	-AG-FR8-TB8-12S	1.16 (29.5)	0.75 (19.1)	0.04 (1.0)	0.40 (10.2)	0.55 (14.0)	3500 (241)	2800 (192)	3500 (241)

FR Gland to Short Metric Automatic Tube Butt Weld											
FR Size (in.)	Tube O.D. (mm)	Nominal Wall Thickness (mm)	Basic Ordering Number	Dimensions, mm (in.)					Working Pressure, bar (psig)		
				L	B	D	E	Tx	6L	CU	NI
1/4	6	1.0	-AG-FR4-MTB6-12S	30.0 (1.18)	19.1 (0.75)	0.5 (0.02)	4.0 (0.16)	6.8 (0.27)	468 (6800)	372 (5400)	468 (6800)
1/4	8	1.0	-AG-FR4-MTB8-12S	30.2 (1.19)	19.1 (0.75)	0.8 (0.03)	6.0 (0.24)	8.9 (0.35)	337 (4900)	337 (4900)	337 (4900)
1/2	10	1.0	-AG-FR8-MTB10-12S	31.0 (1.22)	19.1 (0.75)	0.8 (0.03)	8.0 (0.31)	10.9 (0.43)	241 (3500)	192 (2800)	241 (3500)
1/2	12	1.0	-AG-FR8-MTB12-12S	30.5 (1.20)	19.1 (0.75)	1.0 (0.04)	10.0 (0.39)	13.2 (0.52)	213 (3100)	165 (2400)	213 (3100)

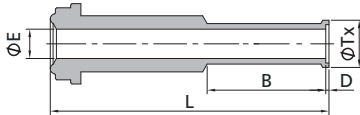
FR Gland to Long Fractional Automatic Tube Butt Weld

FR Size (in.)	Tube O.D. (in.)	Nominal Wall Thickness (in.)	Basic Ordering Number	Dimensions, in. (mm)					Working Pressure, psig (bar)		
				L	B	D	E	Tx	6L	CU	NI
1/4	1/4	0.035	-AG-FR4-TB4-12	1.72 (43.7)	0.75 (19.1)	0.02 (0.5)	0.18 (4.6)	0.29 (7.4)	5100 (351)	5100 (351)	5100 (351)
1/2	1/4	0.035	-AG-FR8-TB4-12	1.82 (46.2)	0.75 (19.1)	0.02 (0.5)	0.18 (4.6)	0.29 (7.4)	3500 (241)	2800 (192)	3500 (241)
1/2	3/8	0.035	-AG-FR8-TB6-12	1.82 (46.2)	0.75 (19.1)	0.03 (0.8)	0.31 (7.9)	0.41 (10.4)	3300 (227)	2600 (179)	3300 (227)
1/2	1/2	0.049	-AG-FR8-TB8-12	1.83 (46.5)	0.75 (19.1)	0.04 (1.0)	0.40 (10.2)	0.55 (14.0)	3500 (241)	2800 (192)	3500 (241)
3/4	3/4	0.049	-AG-FR12-TB12-12	2.07 (52.6)	0.75 (19.1)	0.04 (1.0)	0.65 (16.5)	0.80 (20.3)	2400 (165)	2400 (165)	2400 (165)
1	1	0.065	-AG-FR16-TB16-16	2.57 (65.3)	0.96 (24.4)	0.04 (1.0)	0.87 (22.1)	1.06 (26.9)	2400 (165)	1900 (130)	2400 (165)

FR Gland to Long Metric Automatic Tube Butt Weld

FR Size (in.)	Tube O.D. (mm)	Nominal Wall Thickness (mm)	Basic Ordering Number	Dimensions, mm (in.)					Working Pressure, bar (psig)		
				L	B	D	E	Tx	6L	CU	NI
1/4	6	1.0	-AG-FR4-MTB6-12	43.7 (1.72)	19.1 (0.75)	0.5 (0.02)	4.0 (0.16)	6.8 (0.27)	468 (6800)	372 (5400)	468 (6800)
1/2	12	1.0	-AG-FR8-MTB12-12	46.5 (1.83)	19.1 (0.75)	1.0 (0.04)	10.0 (0.39)	13.2 (0.52)	213 (3100)	165 (2400)	213 (3100)
3/4	18	1.5	-AG-FR12-MTB18-12	52.6 (2.07)	19.1 (0.75)	1.0 (0.04)	15.0 (0.59)	19.3 (0.76)	206 (3000)	165 (2400)	206 (3000)

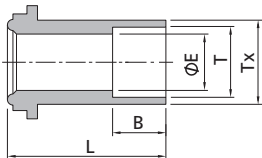
FR Gland to Short Tube Socket Weld

FR Size (in.)	T-Tube O.D. (in.)	Basic Ordering Number	Dimensions, in. (mm)				Working Pressure, psig (bar)		
			L	B	E	Tx	6L	CU	NI
1/4	1/4	-G-FR4-TS4-0.50	0.50 (12.7)	0.28 (7.1)	0.18 (4.6)	0.35 (8.9)	5500 (378)	5500 (378)	5500 (378)
1/4	1/4	-G-FR4-TS4-0.75	0.75 (19.1)	0.28 (7.1)	0.18 (4.6)	0.35 (8.9)	5500 (378)	5500 (378)	5500 (378)

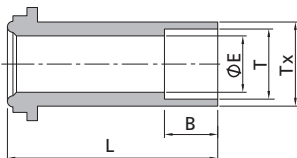
FR Gland to Tube Socket Weld

FR Size (in.)	T-Tube O.D. (in.)	Basic Ordering Number	Dimensions, in. (mm)				Working Pressure, psig (bar)		
			L	B	E	Tx	6L	CU	NI
1/8	1/16	-G-FR2-TS1	0.70 (17.8)	0.10 (2.5)	0.05 (1.3)	0.13 (3.3)	9000 (620)	7200 (496)	9000 (620)
1/8	1/8	-G-FR2-TS2	0.70 (17.8)	0.10 (2.5)	0.09 (2.3)	0.20 (5.1)	7100 (489)	7100 (489)	7100 (489)
1/4	1/4	-G-FR4-TS4	1.31 (33.3)	0.28 (7.1)	0.18 (4.6)	0.35 (8.9)	5500 (378)	5500 (378)	5500 (378)
1/2	3/8	-G-FR8-TS6	1.50 (38.1)	0.31 (7.9)	0.28 (7.1)	0.60 (15.2)	4300 (296)	2800 (192)	3500 (241)
1/2	1/2	-G-FR8-TS8	1.50 (38.1)	0.38 (9.7)	0.40 (10.2)	0.60 (15.2)	3000 (206)	2400 (165)	3000 (206)
5/8	5/8	-G-FR10-TS10	1.56 (39.6)	0.41 (10.4)	0.50 (12.7)	0.72 (18.3)	2800 (192)	2200 (151)	2800 (192)
3/4	3/4	-G-FR12-TS12	2.00 (50.8)	0.44 (11.2)	0.62 (15.7)	0.88 (22.4)	2800 (192)	2200 (151)	2800 (192)
1	1	-G-FR16-TS16	2.22 (56.4)	0.62 (15.7)	0.87 (22.1)	1.19 (30.2)	3000 (206)	1900 (130)	2400 (165)

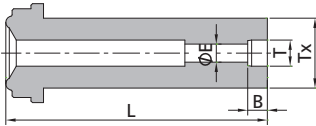

Reducing Socket Weld									
FR Size (in.)	T-Tube O.D. (in.)	Basic Ordering Number	Dimensions, in. (mm)				Working Pressure, psig (bar)		
			L	B	E	Tx	6L	CU	NI
1/4	1/8	-G-FR4-RTS2	1.31 (33.3)	0.10 (2.5)	0.09 (2.3)	0.35 (8.9)	8000 (551)	8000 (551)	8000 (551)
1/2	1/4	-G-FR8-RTS4	1.50 (38.1)	0.28 (7.1)	0.18 (4.6)	0.60 (15.2)	3500 (241)	3500 (241)	3500 (241)

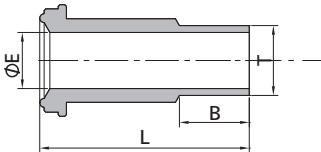

FR Gland to Male Weld									
FR Size (in.)	T-Tube O.D. (in.)	Basic Ordering Number	Dimensions, in. (mm)			Working Pressure, psig (bar)			
			L	B	E	6L	CU	NI	
1/8	1/8	-G-FR2-TB2	0.70 (17.8)	0.28 (7.1)	0.06 (1.5)	11200 (772)	7200 (496)	9000 (620)	
1/4	1/8	-G-FR4-TB2	1.31 (33.3)	0.28 (7.1)	0.06 (1.5)	10000 (690)	6400 (440)	8000 (551)	
1/4	1/4	-G-FR4-TB4	1.31 (33.3)	0.41 (10.4)	0.12 (3.0)	10000 (690)	6400 (440)	8000 (551)	
1/2	1/4	-G-FR8-TB4	1.50 (38.1)	0.41 (10.4)	0.12 (3.0)	4300 (296)	2800 (192)	3500 (241)	
1/2	3/8	-G-FR8-TB6	1.50 (38.1)	0.41 (10.4)	0.28 (7.1)	4300 (296)	2800 (192)	3500 (241)	
1/2	1/2	-G-FR8-TB8	1.50 (38.1)	0.50 (12.7)	0.40 (10.2)	3500 (241)	3500 (241)	3500 (241)	
3/4	3/4	-G-FR12-TB12	2.00 (50.8)	0.62 (15.7)	0.53 (13.5)	3700 (254)	2400 (165)	3000 (206)	
1	1	-G-FR16-TB16	2.22 (56.4)	0.81 (20.6)	0.75 (19.1)	3000 (206)	1900 (130)	2400 (165)	

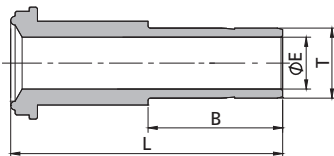

FR Gland to Tube Port									
FR Size (in.)	T-Tube O.D. (in.)	Basic Ordering Number	Dimensions, in. (mm)			Working Pressure, psig (bar)			
			L	B	E	6L	CU	NI	
1/4	1/4	-G-FR4-FT4	1.62 (41.0)	0.64 (16.2)	0.17 (4.3)	10000 (690)	6400 (440)	8000 (551)	
1/2	3/8	-G-FR8-FT6	1.81 (46.0)	0.70 (17.8)	0.27 (6.9)	4300 (296)	2800 (192)	3500 (241)	
1/2	1/2	-G-FR8-FT8	1.94 (49.3)	0.96 (24.4)	0.37 (9.4)	4300 (296)	2800 (192)	3500 (241)	

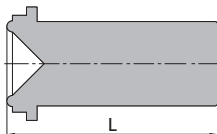

Blind Gland		
FR Size (in.)	Basic Ordering Number	Dimensions, in. (mm)
		L
1/8	-G-FR2-B	0.70 (17.8)
1/4	-G-FR4-B	1.31 (33.3)
1/2	-G-FR8-B	1.50 (38.1)
3/4	-G-FR12-B	2.00 (50.8)
1	-G-FR16-B	2.22 (56.4)

Bodies

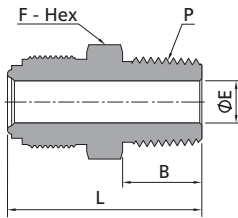
FR Body to Male NPT

FR Size (in.)	P-NPT Size	Basic Ordering Number	Dimensions, in. (mm)				Working Pressure, psig (bar)		
			L	B	E	F	6L	CU	NI
1/8	1/16	-CM-FR2-NS1	1.07 (27.2)	0.38 (9.7)	0.09 (2.3)	3/8 (9.5)	9000 (620)	7200 (496)	9000 (620)
1/8	1/8	-CM-FR2-NS2	1.07 (27.2)	0.38 (9.7)	0.09 (2.3)	7/16 (11.1)	9000 (620)	7200 (496)	9000 (620)
1/4	1/8	-CM-FR4-NS2	1.31 (33.3)	0.38 (9.7)	0.18 (4.6)	5/8 (15.9)	10000 (690)	6400 (440)	8000 (551)
1/4	1/4	-CM-FR4-NS4	1.49 (37.8)	0.56 (14.2)	0.18 (4.6)	5/8 (15.9)	10000 (690)	6400 (440)	8000 (551)
1/2	1/4	-CM-FR8-NS4	1.65 (41.9)	0.56 (14.2)	0.28 (7.1)	15/16 (23.8)	4300 (296)	2800 (192)	3500 (241)
1/2	3/8	-CM-FR8-NS6	1.65 (41.9)	0.56 (14.2)	0.38 (9.7)	15/16 (23.8)	4300 (296)	2800 (192)	3500 (241)
1/2	1/2	-CM-FR8-NS8	1.84 (46.7)	0.75 (19.1)	0.40 (10.2)	15/16 (23.8)	4300 (296)	2800 (192)	3500 (241)
3/4	3/4	-CM-FR12-NS12	2.19 (55.6)	0.75 (19.1)	0.62 (15.7)	1 15/16 (33.3)	3700 (254)	2400 (165)	3000 (206)
1	1	-CM-FR16-NS16	2.47 (62.7)	0.94 (23.9)	0.87 (22.1)	1 5/8 (41.3)	3000 (206)	1900 (130)	3000 (206)

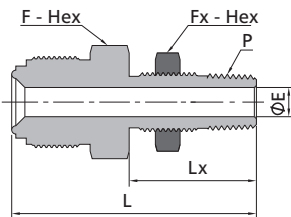

FR Body to Bulkhead Male Connector

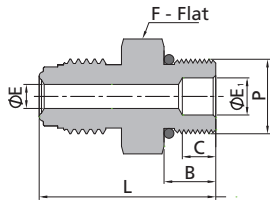
FR Size (in.)	P-NPT Size	Basic Ordering Number	Dimensions, in. (mm)					Panel Hole Size in. (mm)	Max. Panel Thickness in. (mm)	Working Pressure, psig (bar)		
			L	Lx	E	F	Fx			6L	CU	NI
1/4	1/4	-CMB-FR4-NS4	2.21 (56.1)	1.24 (31.5)	0.28 (7.1)	13/16 (20.6)	13/16 (20.6)	21/32 (16.7)	0.38 (9.7)	8000 (551)	6400 (440)	8000 (551)
1/2	1/4	-CMB-FR8-NS4	2.34 (59.4)	1.24 (31.5)	0.28 (7.1)	15/16 (23.8)	13/16 (20.6)	21/32 (16.7)	0.38 (9.7)	4370 (301)	2800 (192)	3500 (241)

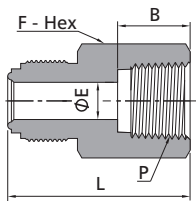

FR Body to SAE/MS Thread												
FR Size (in.)	P-SAE/MS Thread Size	Uniform O-ring ^① Size	Basic Ordering Number	Dimensions, in. (mm)						Working Pressure, psig (bar)		
				L	B	C	E	E ₁	F	6L	CU	NI
1/4	9/16-18	906	-CM-FR4-ST9	1.33 (33.8)	0.39 (9.9)	0.25 (6.4)	0.18 (4.6)	0.28 (7.1)	3/4 (19.1)	4500 (310)	4500 (310)	4500 (310)
1/2	9/16-18	906	-CM-FR8-ST9	1.48 (37.6)	0.39 (9.9)	-	0.28 (7.1)	0.28 (7.1)	15/16 (23.8)	3500 (241)	2800 (192)	3500 (241)
1/2	7/8-14	910	-CM-FR8-ST14	1.66 (42.2)	0.50 (12.7)	0.40 (10.2)	0.28 (7.1)	0.59 (15.0)	1 (25.4)	3500 (241)	2800 (192)	3500 (241)

① Fluorocarbon FKM is standard O-ring material, contact FITOK Group for other materials.



FR Body to Female NPT									
FR Size (in.)	P-NPT Size	Basic Ordering Number	Dimensions, in. (mm)				Working Pressure, psig (bar)		
			L	B	E	F	6L	CU	NI
1/8	1/16	-CF-FR2-NS1	1.10 (27.9)	0.39 (9.9)	0.09 (2.3)	7/16 (11.1)	6700 (461)	6700 (461)	6700 (461)
1/8	1/8	-CF-FR2-NS2	1.19 (30.2)	0.41 (10.4)	0.09 (2.3)	9/16 (14.3)	6500 (447)	6500 (447)	6500 (447)
1/4	1/8	-CF-FR4-NS2	1.41 (35.8)	0.41 (10.4)	0.18 (4.6)	5/8 (15.9)	8000 (551)	6400 (440)	8000 (551)
1/4	1/4	-CF-FR4-NS4	1.54 (39.1)	0.59 (15.0)	0.18 (4.6)	3/4 (19.1)	6600 (454)	5200 (358)	6600 (454)
1/2	3/8	-CF-FR8-NS6	1.76 (44.7)	0.59 (15.0)	0.40 (10.2)	15/16 (23.8)	4300 (296)	2800 (192)	3500 (241)
1/2	1/2	-CF-FR8-NS8	1.99 (50.5)	0.78 (19.8)	0.40 (10.2)	1 1/16 (27.0)	4300 (296)	2800 (192)	3500 (241)
3/4	3/4	-CF-FR12-NS12	2.36 (59.9)	0.81 (20.6)	0.62 (15.7)	1 5/16 (33.3)	3700 (254)	2400 (165)	3000 (206)
1	1	-CF-FR16-NS16	2.51 (63.8)	1.00 (25.4)	0.87 (22.1)	1 5/8 (41.3)	3000 (206)	1900 (130)	2400 (165)

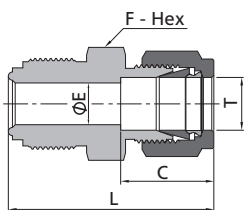

FR Body to Tube Fitting									
FR Size (in.)	T-Tube O.D. (in.)	Basic Ordering Number	Dimensions, in. (mm)				Working Pressure, psig (bar)		
			L ^①	C	E	F	6L	CU	NI
1/4	1/8	-U-FR4-FL2	1.53 (38.9)	0.50 (12.7)	0.09 (2.3)	5/8 (15.9)	10000 (690)	6400 (440)	8000 (551)
1/4	1/4	-U-FR4-FL4	1.62 (41.1)	0.60 (15.2)	0.18 (4.6)	5/8 (15.9)	10000 (690)	6400 (440)	8000 (551)
1/2	3/8	-U-FR8-FL6	1.84 (46.7)	0.66 (16.8)	0.28 (7.1)	15/16 (23.8)	4300 (296)	2800 (192)	3500 (241)
1/2	1/2	-U-FR8-FL8	1.95 (49.5)	0.90 (22.9)	0.40 (10.2)	15/16 (23.8)	4300 (296)	2800 (192)	3500 (241)

① Dimension L is with FITOK nuts finger-tight.

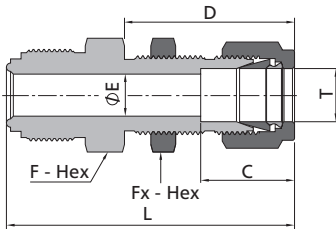

FR Body to Bulkhead Tube Fitting Union

FR T-Tube Size (in.)	O.D. (in.)	Basic Ordering Number	Dimensions, in. (mm)						Panel Hole Size in. (mm)	Max. Panel Thickness in. (mm)	Working Pressure, psig (bar)		
			L ^①	C	D	E	F	Fx			6L	CU	NI
1/4	1/4	-UB-FR4-FL4	2.25 (57.2)	0.60 (15.2)	1.32 (33.5)	0.18 (4.6)	5/8 (15.9)	5/8 (15.9)	15/32 (11.9)	0.40 (10.2)	10000 (690)	6400 (440)	8000 (551)
1/4	1/4	-UB-FR4-FL4-1.88	1.88 (47.8)	0.60 (15.2)	1.05 (26.7)	0.18 (4.6)	5/8 (15.9)	5/8 (15.9)	15/32 (11.9)	0.13 (3.3)	10000 (690)	6400 (440)	8000 (551)
1/2	3/8	-UB-FR8-FL6	2.54 (64.5)	0.66 (16.8)	1.45 (36.8)	0.28 (7.1)	15/16 (23.8)	3/4 (19.1)	19/32 (15.0)	0.44 (11.2)	4300 (296)	2800 (192)	3500 (241)
1/2	1/2	-UB-FR8-FL8	2.74 (69.6)	0.90 (22.9)	1.65 (41.9)	0.40 (10.2)	15/16 (23.8)	15/16 (23.8)	25/32 (19.8)	0.50 (12.7)	4300 (296)	2800 (192)	3500 (241)

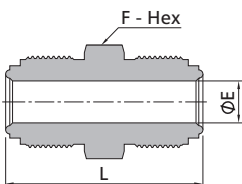
① Dimension L is with FITOK nuts finger-tight.

Union Body

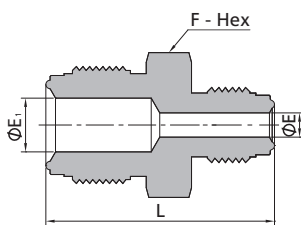
FR Size (in.)	FR Size (in.)	Basic Ordering Number	Dimensions, in. (mm)			Working Pressure, psig (bar)		
			L	E	F	6L	CU	NI
1/8	1/8	-U-FR2	1.13 (28.7)	0.09 (2.3)	3/8 (9.5)	11200 (772)	7200 (496)	9000 (620)
1/4	1/4	-U-FR4	1.55 (39.4)	0.18 (4.6)	5/8 (15.9)	10000 (690)	6400 (440)	8000 (551)
1/2	1/2	-U-FR8	1.84 (46.7)	0.40 (10.2)	15/16 (23.8)	4300 (296)	2800 (192)	3500 (241)
3/4	3/4	-U-FR12	2.44 (62.0)	0.62 (15.7)	1 5/16 (33.3)	3700 (254)	2400 (165)	3000 (206)
1	1	-U-FR16	2.59 (65.8)	0.87 (22.1)	1 5/8 (41.3)	3000 (206)	1900 (130)	2400 (165)

Reducing Union

FR Size (in.)	FR Size (in.)	Basic Ordering Number	Dimensions, in. (mm)				Working Pressure, psig (bar)		
			L	E	E ₁	F	6L	CU	NI
1/4	1/8	-U-FR4-FR2	1.37 (34.8)	0.09 (2.3)	0.18 (4.6)	5/8 (15.9)	10000 (690)	6400 (440)	8000 (551)
1/2	1/4	-U-FR8-FR4	1.71 (43.4)	0.18 (4.6)	0.40 (10.2)	5/16 (23.8)	4300 (296)	2800 (192)	3500 (241)

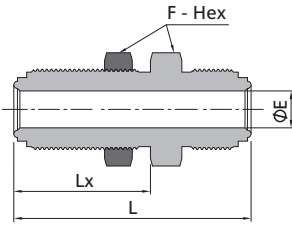

Bulkhead Union Body										
FR Size (in.)	Basic Ordering Number	Dimensions, in. (mm)				Panel Hole Drill Size in. (mm)	Max. Panel Thickness in. (mm)	Working Pressure, psig (bar)		
		L	Lx	E	F			6L	CU	NI
1/4	-BU-FR4-1.82	1.82 (46.2)	0.99 (25.1)	0.18 (4.6)	3/4 (19.1)	19/32 (15.0)	0.13 (3.3)	10000 (690)	6400 (440)	8000 (551)
1/4	-BU-FR4	2.23 (56.6)	1.30 (33.3)	0.18 (4.6)	3/4 (19.1)	19/32 (15.0)	0.44 (11.2)	10000 (690)	6400 (440)	8000 (551)
1/2	-BU-FR8-2.14	2.14 (54.4)	1.11 (28.2)	0.40 (10.2)	1 1/16 (27.0)	29/32 (23.1)	0.13 (3.3)	4300 (296)	2800 (192)	3500 (241)
1/2	-BU-FR8	2.57 (65.3)	1.48 (37.6)	0.40 (10.2)	1 1/16 (27.0)	29/32 (23.1)	0.50 (12.7)	4300 (296)	2800 (192)	3500 (241)

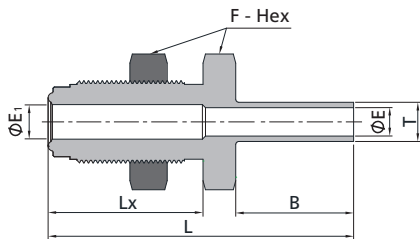

FR Bulkhead Body to Tube Butt Weld													
FR Size (in.)	T-Tube O.D. (in.)	Basic Ordering Number	Dimensions, in. (mm)					Panel Hole Drill Size in. (mm)	Max. Panel Thickness in. (mm)	Working Pressure, psig (bar)			
			L	Lx	B	E	E ₁			F	6L	CU	NI
1/4	1/4	-BW-FR4-TB4-1.95	1.95 (49.5)	0.99 (25.1)	0.75 (19.1)	0.18 (4.6)	0.22 (5.6)	0.75 (19.1)	19/32 (15.1)	0.13 (3.3)	5100 (351)	5100 (351)	5100 (351)
1/4	1/4	-BW-FR4-TB4	2.36 (59.9)	1.30 (33.0)	0.75 (19.1)	0.18 (4.6)	0.22 (5.6)	0.75 (19.1)	19/32 (15.1)	0.44 (11.2)	5100 (351)	5100 (351)	5100 (351)

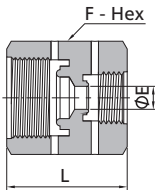

Female Reducing Union									
FR Size (in.)	FR Size (in.)	Basic Ordering Number	Dimensions, in. (mm)			Working Pressure, psig (bar)			
			L	E	F	6L	CU	NI	
1/4	1/8	-RU-FR4-FR2	1.16 (29.5)	0.13 (3.3)	3/4 (19.1)	10000 (690)	6400 (440)	8000 (551)	
1/2	1/4	-RU-FR8-FR4	1.41 (35.8)	0.25 (6.4)	1 1/16 (27.0)	4300 (296)	2800 (192)	3500 (241)	

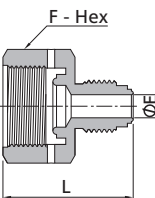

Reducing Adapter									
FR Size (in.)	FR Size (in.)	Basic Ordering Number	Dimensions, in. (mm)			Working Pressure, psig (bar)			
			L	E	F	6L	CU	NI	
1/4	1/8	-RA-FR4-FR2	1.19 (30.2)	0.09 (2.3)	3/4 (19.1)	10000 (690)	6400 (440)	8000 (551)	
1/2	1/4	-RA-FR8-FR4	1.41 (35.8)	0.18 (4.6)	1 1/16 (27.0)	4300 (296)	2800 (192)	3500 (241)	

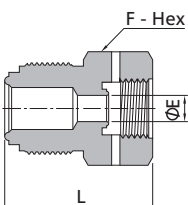

Reducing Bushing									
FR Size (in.)	FR Size (in.)	Basic Ordering Number	Dimensions, in. (mm)			Working Pressure, psig (bar)			
			L	E	F	6L	CU	NI	
1/4	1/8	-RB-FR4-FR2	1.06 (26.9)	0.13 (3.3)	5/8 (15.9)	10000 (690)	6400 (440)	8000 (551)	
1/2	1/4	-RB-FR8-FR4	1.41 (35.8)	0.25 (6.4)	15/16 (23.8)	4300 (296)	2800 (192)	3500 (241)	

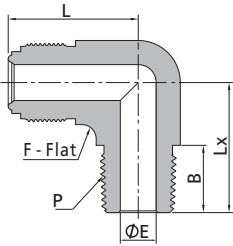

FR Body to Male NPT Elbow										
FR Size (in.)	P-NPT Size	Basic Ordering Number	Dimensions, in. (mm)					Working Pressure, psig (bar)		
			L	Lx	B	E	F	6L	CU	NI
1/4	1/8	-LM-FR4-NS2	1.07 (27.2)	0.87 (22.1)	0.38 (9.6)	0.18 (4.6)	1/2 (12.7)	10000 (690)	6400 (440)	8000 (551)
1/4	1/4	-LM-FR4-NS4	1.07 (27.2)	1.05 (26.7)	0.56 (14.2)	0.18 (4.6)	1/2 (12.7)	8000 (551)	8000 (551)	8000 (551)
1/2	3/8	-LM-FR8-NS6	1.45 (36.8)	1.26 (32.0)	0.56 (14.2)	0.40 (10.2)	13/16 (20.6)	4300 (296)	2800 (192)	3500 (241)
1/2	1/2	-LM-FR8-NS8	1.45 (36.8)	1.45 (36.8)	0.75 (19.1)	0.40 (10.2)	13/16 (20.6)	4300 (296)	2800 (192)	3500 (241)

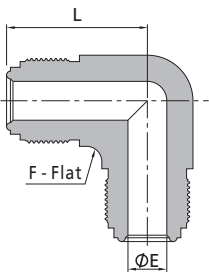

FR Body Union Elbow							
FR Size (in.)	Basic Ordering Number	Dimensions, in. (mm)			Working Pressure, psig (bar)		
		L	E	F	6L	CU	NI
1/8	-LU-FR2	0.89 (22.6)	0.09 (2.3)	7/16 (11.1)	11200 (772)	7200 (496)	9000 (620)
1/4	-LU-FR4	1.07 (27.2)	0.18 (4.6)	1/2 (12.7)	10000 (690)	6400 (440)	8000 (551)
1/2	-LU-FR8	1.45 (36.8)	0.40 (10.2)	13/16 (20.6)	4300 (296)	2800 (192)	3500 (241)
3/4	-LU-FR12	1.92 (48.8)	0.62 (15.7)	1 1/4 (31.8)	3700 (254)	2400 (165)	3000 (206)
1	-LU-FR16	2.00 (50.8)	0.87 (22.1)	1 11/16 (42.9)	3000 (206)	1900 (130)	2400 (165)

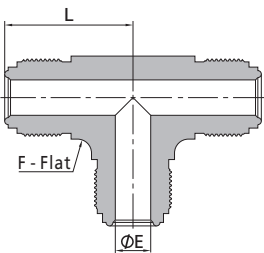

FR Body Union Tee							
FR Size (in.)	Basic Ordering Number	Dimensions, in. (mm)			Working Pressure, psig (bar)		
		L	E	F	6L	CU	NI
1/8	-TTT-FR2	0.89 (22.6)	0.09 (2.3)	7/16 (11.1)	11200 (772)	7200 (496)	9000 (620)
1/4	-TTT-FR4	1.07 (27.2)	0.18 (4.6)	1/2 (12.7)	10000 (690)	6400 (440)	8000 (551)
1/2	-TTT-FR8	1.45 (36.8)	0.40 (10.2)	13/16 (20.6)	4300 (296)	2800 (192)	3500 (241)
3/4	-TTT-FR12	1.92 (48.8)	0.62 (15.7)	1 1/4 (31.8)	3700 (254)	2400 (165)	3000 (206)
1	-TTT-FR16	2.00 (50.8)	0.87 (22.1)	1 11/16 (42.9)	3000 (206)	1900 (130)	2400 (165)

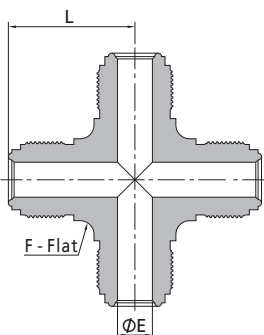

FR Body Union Cross							
FR Size (in.)	Basic Ordering Number	Dimensions, in. (mm)			Working Pressure, psig (bar)		
		L	E	F	6L	CU	NI
1/8	-C-FR2	0.89 (22.6)	0.09 (2.3)	7/16 (11.1)	11200 (772)	7200 (496)	9000 (620)
1/4	-C-FR4	1.07 (27.2)	0.18 (4.6)	1/2 (12.7)	10000 (690)	6400 (440)	8000 (551)
1/2	-C-FR8	1.45 (36.8)	0.40 (10.2)	13/16 (20.6)	4300 (296)	2800 (192)	3500 (241)
3/4	-C-FR12	1.92 (48.8)	0.62 (15.7)	1 1/4 (31.8)	3700 (254)	2400 (165)	3000 (206)
1	-C-FR16	2.00 (50.8)	0.87 (22.1)	1 11/16 (42.9)	3000 (206)	1900 (130)	2400 (165)

Welded Glands

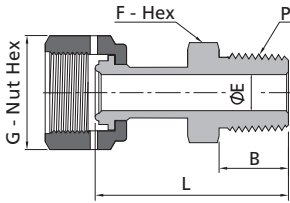

FR Welded Gland to Male NPT										
FR Size (in.)	P-NPT Size	Basic Ordering Number	Dimensions, in. (mm)					Working Pressure, psig (bar)		
			L	B	E	G	F	6L	CU	NI
1/4	1/8	-WG-FR4-NS2	1.58 (40.1)	0.38 (9.7)	0.18 (4.6)	3/4 (19.1)	7/16 (11.1)	8000 (551)	6400 (446)	8000 (551)
1/4	1/4	-WG-FR4-NS4	1.79 (45.5)	0.56 (14.2)	0.18 (4.6)	3/4 (19.1)	9/16 (14.3)	8000 (551)	6400 (446)	8000 (551)
1/2	3/8	-WG-FR8-NS6	1.89 (48.0)	0.56 (14.2)	0.40 (10.2)	1 1/16 (27.0)	11/16 (17.5)	4300 (296)	2800 (192)	3500 (241)
1/2	1/2	-WG-FR8-NS8	2.09 (53.1)	0.75 (19.1)	0.40 (10.2)	1 1/16 (27.0)	7/8 (22.2)	4300 (296)	2800 (192)	3500 (241)

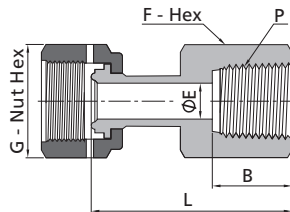

FR Welded Gland to Female NPT										
FR Size (in.)	P-NPT Size	Basic Ordering Number	Dimensions, in. (mm)					Working Pressure, psig (bar)		
			L	B	E	G	F	6L	CU	NI
1/4	1/4	-WG-FR4-FNS4	1.77 (45.0)	0.59 (15.0)	0.18 (4.6)	3/4 (19.1)	3/4 (19.1)	6600 (454)	5200 (458)	6600 (454)
1/2	3/8	-WG-FR8-FNS6	1.95 (49.5)	0.59 (15.0)	0.40 (10.2)	1 1/16 (27.0)	7/8 (22.2)	4300 (296)	2800 (192)	3500 (241)
1/2	1/2	-WG-FR8-FNS8	2.18 (55.4)	0.78 (19.8)	0.40 (10.2)	1 1/16 (27.0)	1 1/16 (27.0)	4300 (296)	2800 (192)	3500 (241)

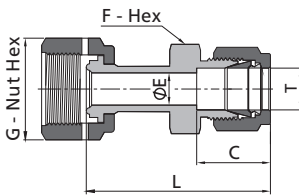

FR Welded Gland to Tube Fitting										
FR Size (in.)	T-Tube O.D. (in.)	Basic Ordering Number	Dimensions, in. (mm)					Working Pressure, psig (bar)		
			L ^①	C	E	G	F	6L	CU	NI
1/4	1/4	-WG-FR4-FL4	1.94 (49.3)	0.60 (15.2)	0.18 (4.6)	3/4 (19.1)	1/2 (12.7)	8000 (551)	6400 (440)	8000 (551)
1/4	3/8	-WG-FR4-FL6	1.97 (50.0)	0.66 (16.8)	0.18 (4.6)	3/4 (19.1)	5/8 (15.9)	6500 (447)	5200 (358)	6500 (447)
1/2	1/2	-WG-FR8-FL8	2.23 (56.6)	0.90 (22.9)	0.40 (10.2)	1 1/16 (27.0)	13/16 (20.6)	4300 (296)	2800 (192)	3500 (241)

① Dimension L is with FITOK nuts finger-tight.

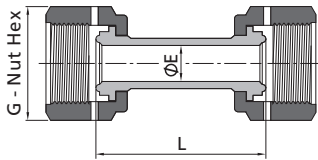

FR Welded Gland Union							
FR Size (in.)	Basic Ordering Number	Dimensions, in. (mm)			Working Pressure, psig (bar)		
		L	E	G	6L	CU	NI
1/4	-WG-FR4	1.71 (43.4)	0.18 (4.6)	3/4 (19.1)	8000 (551)	6400 (440)	8000 (551)
1/2	-WG-FR8	1.84 (46.7)	0.40 (10.2)	1 1/16 (27.0)	4300 (296)	2800 (192)	3500 (241)

Female Elbows

Basic ordering number: -LWG-FR4

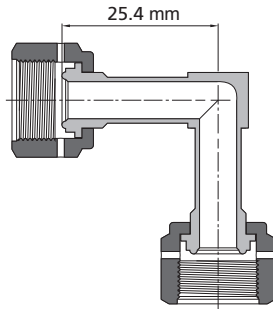

Female Tees

Basic ordering number: -TWG-FR4

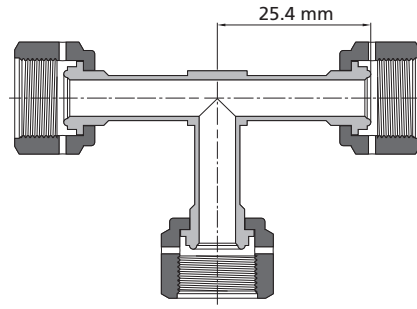

Nuts

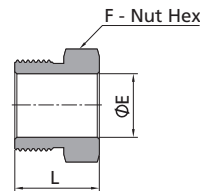
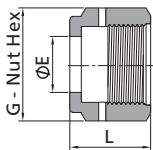

Female Nut				
FR Size (in.)	Basic Ordering Number	Dimensions, in. (mm)		
		L	E	G
1/8	-N-FR2	0.53 (13.5)	0.21 (5.3)	7/16 (11.1)
1/4	-N-FR4	0.81 (20.6)	0.36 (9.1)	3/4 (19.1)
1/2	-N-FR8	0.88 (22.4)	0.61 (15.5)	1 1/16 (27.0)
5/8	-N-FR10	0.88 (22.4)	0.74 (18.8)	1 3/16 (30.2)
3/4	-N-FR12	1.12 (28.4)	0.89 (22.6)	1 1/2 (38.1)
1	-N-FR16	1.34 (34.0)	1.20 (30.5)	1 3/4 (44.5)

Male Nut				
FR Size (in.)	Basic Ordering Number	Dimensions, in. (mm)		
		L	E	F
1/8	-MN-FR2	0.50 (12.7)	0.21 (5.3)	3/8 (9.5)
1/4	-MN-FR4	0.71 (18.0)	0.36 (9.1)	5/8 (15.9)
1/2	-MN-FR8	0.81 (20.6)	0.61 (15.5)	15/16 (23.8)
5/8	-MN-FR10	0.81 (20.6)	0.74 (18.8)	1 1/16 (27.0)
3/4	-MN-FR12	1.00 (25.4)	0.89 (22.6)	1 5/16 (33.3)
1	-MN-FR16	1.19 (30.2)	1.20 (30.5)	1 5/8 (41.3)

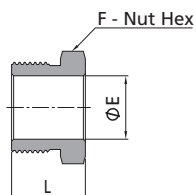

Short Male Nut				
FR Size (in.)	Basic Ordering Number	Dimensions, in. (mm)		
		L	E	F
1/4	-MN-FR4-0.54	0.54 (13.7)	0.36 (9.1)	5/8 (15.9)
1/4	-MN-FR4-0.65	0.65 (16.5)	0.36 (9.1)	5/8 (15.9)

For use with Gland to Short Tube Butt Weld

Split-Nut Assemblies

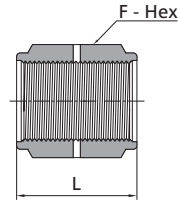
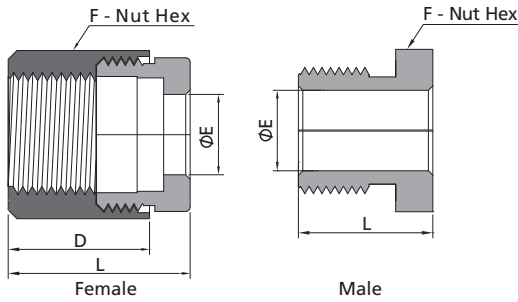

Split-Nut Assemblies						
FR Size (in.)	Split Nut Type	Basic Ordering Number	Dimensions, in. (mm)			
			L	E	F	D
1/4	Female	-N-FR4-SN	0.81 (20.6)	0.36 (9.1)	3/4 (19.1)	0.63 (16.0)
1/4	Male	-MN-FR4-SN	0.60 (15.2)	0.36 (9.1)	5/8 (15.9)	-

Coupling			
FR Size (in.)	Basic Ordering Number	Dimensions, in. (mm)	
		L	F
1/8	-BC-FR2	0.66 (16.8)	7/16 (11.1)
1/4	-BC-FR4	1.19 (30.2)	3/4 (19.1)
1/2	-BC-FR8	1.31 (33.3)	1 1/16 (27.0)
3/4	-BC-FR12	1.68 (42.7)	1 1/2 (38.1)
1	-BC-FR16	2.04 (51.8)	1 3/4 (44.5)

Plugs

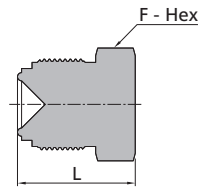

Plug			
FR Size (in.)	Basic Ordering Number	Dimensions, in. (mm)	
		L	F
1/8	-PG-FR2	0.68 (17.3)	3/8 (9.5)
1/4	-PG-FR4	0.92 (23.4)	5/8 (15.9)
1/2	-PG-FR8	1.08 (27.4)	15/16 (23.8)
3/4	-PG-FR12	1.43 (36.3)	1 5/16 (33.3)
1	-PG-FR16	1.52 (38.6)	1 5/8 (41.3)

Caps

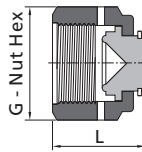

Cap			
FR Size (in.)	Basic Ordering Number	Dimensions, in. (mm)	
		L	G
1/8	-CP-FR2	0.63 (16.0)	7/16 (11.1)
1/4	-CP-FR4	0.94 (23.9)	3/4 (19.1)
1/2	-CP-FR8	1.01 (25.6)	1 1/16 (27.0)
3/4	-CP-FR12	1.29 (32.8)	1 1/2 (38.1)
1	-CP-FR16	1.54 (39.1)	1 3/4 (44.5)

Plugs with Lanyard

- ⦿ Lanyard material: 304 SS.
- ⦿ Lanyard length: 15.2 cm.



Plug with Lanyard			
FR Size (in.)	Basic Ordering Number	Dimensions, in. (mm)	
		L	F
1/4	-PG-FR4-BP	0.92 (23.4)	5/8 (15.9)
1/2	-PG-FR8-BP	1.08 (27.4)	15/16 (23.8)

Caps with Lanyard

- ⦿ Lanyard material: 304 SS.
- ⦿ Lanyard length: 15.2 cm.



Cap with Lanyard			
FR Size (in.)	Basic Ordering Number	Dimensions, in. (mm)	
		L	G
1/4	-CP-FR4-BP	0.94 (23.9)	3/4 (19.1)
1/2	-CP-FR8-BP	1.01 (25.6)	1 1/16 (27.0)

Flow Restrictors

⦿ Working pressure up to: 10,000 psig (690 bar)

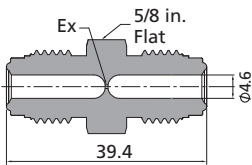

FR Body to Male FR	
Ex, in. (mm)	Ordering Number
0.015 (0.381)	6LV-R-FR4-015
0.017 (0.432)	6LV-R-FR4-017
0.020 (0.508)	6LV-R-FR4-020
0.023 (0.584)	6LV-R-FR4-023
0.025 (0.635)	6LV-R-FR4-025
0.026 (0.660)	6LV-R-FR4-026
0.027 (0.686)	6LV-R-FR4-027
0.030 (0.762)	6LV-R-FR4-030
0.035 (0.889)	6LV-R-FR4-035
0.040 (1.016)	6LV-R-FR4-040
0.045 (1.143)	6LV-R-FR4-045
0.050 (1.270)	6LV-R-FR4-050
0.055 (1.397)	6LV-R-FR4-055
0.060 (1.529)	6LV-R-FR4-060
0.065 (1.651)	6LV-R-FR4-065
0.070 (1.778)	6LV-R-FR4-070
0.075 (1.905)	6LV-R-FR4-075
0.080 (2.032)	6LV-R-FR4-080
0.085 (2.159)	6LV-R-FR4-085
0.090 (2.286)	6LV-R-FR4-090
0.093 (2.362)	6LV-R-FR4-093
0.095 (2.413)	6LV-R-FR4-095
0.100 (2.540)	6LV-R-FR4-100

Locking Device

- ⦿ To help prevent unintentional disassembly of FR connections.
- ⦿ Used for FITOK FR metal gasket face seal assemblies with standard male and female nuts.



Locking Device	
FR Size (in.)	Ordering Number
1/4	S4-FR4-LD
1/2	S4-FR8-LD

Gaskets

- ⦿ Copper gaskets are unplated.
- ⦿ Unplated SS gaskets and Nickel gaskets are electropolished.
- ⦿ If Silver-plated SS or Nickel gaskets are required, please delete the suffix of "-UP" from the ordering number.

Nonretained

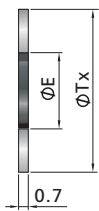

Unplated (UP)			
FR Size (in.)	Basic Ordering Number	Dimensions, in. (mm)	
		Tx	E
1/8	-GT-FR2-UP	0.26 (6.6)	0.09 (2.3)
1/4	-GT-FR4-UP	0.47 (11.9)	0.22 (5.6)
1/2	-GT-FR8-UP	0.78 (19.8)	0.44 (11.2)
5/8	-GT-FR10-UP	0.91 (23.1)	0.58 (14.7)
3/4	-GT-FR12-UP	1.14 (29.0)	0.66 (16.8)
1	-GT-FR16-UP	1.40 (35.6)	0.89 (22.6)

Gaskets are used without retainers.

Gasket Retainer Assemblies

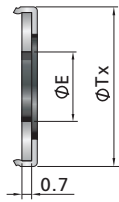

Unplated (UP)			
FR Size (in.)	Basic Ordering Number	Dimensions, mm	
		Tx	E
1/4	-GT-FR4-A-UP	0.50 (12.7)	0.24 (6.1)
1/2	-GT-FR8-A-UP	0.79 (20.1)	0.44 (11.2)
3/4	-GT-FR12-A-UP	1.14 (29.0)	0.66 (16.8)
1	-GT-FR16-A-UP	1.40 (35.6)	0.89 (22.6)

1. Gaskets are used with retainers.
2. Retainer material is 316L SS.
3. Retainers are available in different colors, please contact FITOK Group for more details.

Side-load Retainer

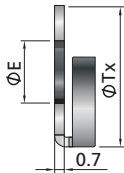

Unplated (UP)			
FR Size (in.)	Basic Ordering Number	Dimensions, in. (mm)	
		Tx	E
1/4	-GT-FR4-AS-UP	0.45 (11.4)	0.24 (6.1)
1/2	-GT-FR8-AS-UP	0.75 (19.1)	0.43 (11.0)

1. Gaskets are only available in 316L SS and Nickel.
2. Silver-plated gaskets are not available.

Blind



Unplated (UP)		
FR Size (in.)	Basic Ordering Number	Dimensions, in. (mm)
		Tx
1/8	-GT-FR2-B-UP	0.26 (6.6)
1/4	-GT-FR4-B-UP	0.47 (11.9)
1/2	-GT-FR8-B-UP	0.78 (19.8)
5/8	-GT-FR10-B-UP	0.91 (23.1)
3/4	-GT-FR12-B-UP	1.14 (29.0)
1	-GT-FR16-B-UP	1.40 (35.6)

Blind gasket retainer assemblies are available, please contact FITOK Group for more details.

Snubber

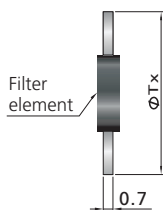

Unplated (UP)		
FR Size (in.)	Basic Ordering Number	Dimensions, mm
		Tx
1/4	-GT-FR4-UP-**M	0.47 (11.9)
1/2	-GT-FR8-UP-**M	0.78 (19.8)
3/4	-GT-FR12-UP-**M	1.14 (29.0)
1	-GT-FR16-UP-**M	1.40 (35.6)

1. Add the designator of filter element precision accuracy as a suffix to the basic ordering number to get the complete ordering number.
Example: For 1/4" 316L SS snubber with filter element precision accuracy of 5 µm, the ordering number is 6L-GT-FR4-UP-5M.

Knurled Gasket

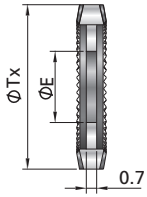

Unplated (UP)			
FR Size (in.)	Basic Ordering Number	Dimensions, in.(mm)	
		Tx	E
1/4	-GT-FR4-KN-A-UP	0.5(12.7)	0.22(5.5)

- Used for nut loose prevention caused by vibration.
- General 316L SS or Nickle gasket is assembled by 1/8 turn, but its installation method is 3/8 turn.

High-Flow Connections - "H" Type FR

"H" type FR connections with high flow capacity are compatible with regular FR connections. Gasket retainer assemblies are recommended to minimize flow resistance.

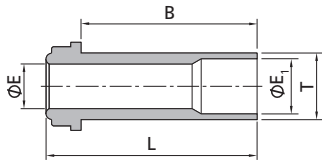

HFR Gland to Tube Butt Weld										
FR Size (in.)	T-Tube O.D. (in.)	Nominal Wall Thickness (in.)	Basic Ordering Number	Dimensions, in. (mm)				Working Pressure, psig (bar)		
				L	B	E	E ₁	6L	CU	NI
1/4	3/8	0.035	-G-HFR4-TB6-0.60	0.60 (15.2)	0.41 (10.4)	0.25 (6.4)	0.31 (7.9)	3300 (227)	3300 (227)	3300 (227)
1/4	3/8	0.035	-G-HFR4-TB6-1.19	1.19 (30.2)	1.00 (25.4)	0.25 (6.4)	0.31 (7.9)	3300 (227)	3300 (227)	3300 (227)
1/4	3/8	0.035	-G-HFR4-TB6-1.31	1.31 (33.3)	1.12 (28.4)	0.25 (6.4)	0.31 (7.9)	3300 (227)	3300 (227)	3300 (227)

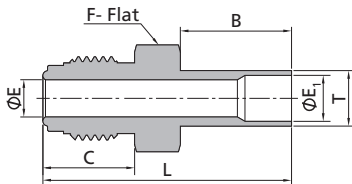

HFR Body to Tube Butt Weld												
FR Size (in.)	T-Tube O.D. (in.)	Basic Ordering Number	Dimensions, in. (mm)						Working Pressure, psig (bar)			
			L	B	C	E	E ₁	F	6L	CU	NI	
1/4	3/8	-CW-HFR4-TB6	1.68 (42.7)	0.75 (19.1)	0.62 (15.7)	0.25 (6.4)	0.31 (7.9)	5/8 (15.9)	3300 (227)	3300 (227)	3300 (227)	

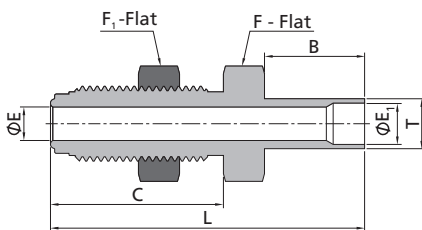

HFR Bulkhead Body to Tube Butt Weld														
FR Size (in.)	T-Tube O.D. (in.)	Basic Ordering Number	Dimensions, in. (mm)								Working Pressure, psig (bar)			
			L	B	C	E	E ₁	F	F ₁	Panel Hole Dia	Max. Panel Thickness	Panel Hole Dia	6L	CU
1/4	3/8	-BW-HFR4-TB6	2.36 (59.9)	0.75 (19.1)	1.30 (33.0)	0.31 (7.9)	0.25 (6.4)	3/4 (19.1)	3/4 (19.1)	19/32 (15.0)	0.44 (11.2)	3300 (227)	3300 (227)	3300 (227)

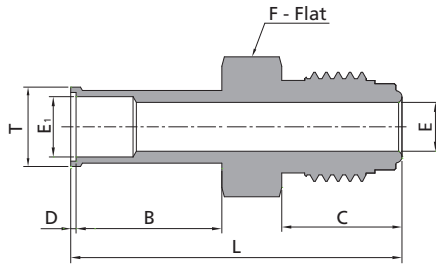

HFR Body to Automatic Tube Weld

FR Size (in.)	Tube Size (in.)	Basic Ordering Number	Dimensions, in. (mm)									Working Pressure, psig (bar)		
			L	B	C	D	E	E ₁	F	T	6L	CU	NI	
1/4	3/8	-AW-HFR4-TB6	1.71 (43.4)	0.75 (19.1)	0.62 (15.7)	0.03 (0.8)	0.25 (6.4)	0.31 (7.9)	5/8 (15.9)	0.41 (10.4)	3300 (227)	3300 (227)	3300 (227)	

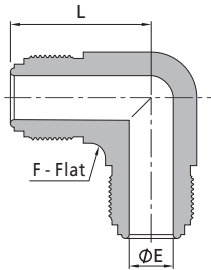

HFR Body Union Elbow

FR Size (in.)	Basic Ordering Number	Dimensions, in. (mm)			Working Pressure, psig (bar)		
		L	E	F	6L	CU	NI
1/4	-LU-HFR4	1.07 (27.2)	0.25 (6.4)	1/2 (12.7)	10000 (690)	6400 (440)	8000 (551)

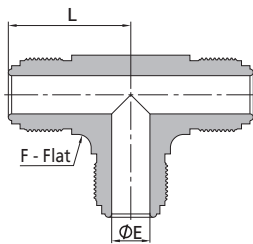

HFR Body Union Tee

FR Size (in.)	Basic Ordering Number	Dimensions, in. (mm)			Working Pressure, psig (bar)		
		L	E	F	6L	CU	NI
1/4	-TTT-HFR4	1.07 (27.2)	0.25 (6.4)	1/2 (12.7)	10000 (690)	6400 (440)	8000 (551)

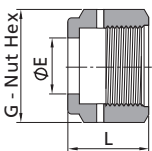

HFR Female Nut

FR Size (in.)	Basic Ordering Number	Dimensions, in. (mm)		
		L	E	G
1/4	-N-HFR4-9.9	0.81 (20.6)	0.39 (9.9)	3/4 (19.1)
1/4	-N-HFR4-11.7	0.81 (20.6)	0.46 (11.7)	3/4 (19.1)

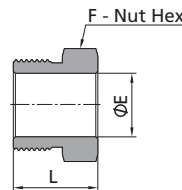

HFR Male Nut

FR Size (in.)	Basic Ordering Number	Dimensions, in. (mm)		
		L	E	F
1/4	-MN-HFR4	0.71 (18.0)	0.39 (9.9)	5/8 (15.9)

FIRTECH

Al. Piłsudskiego 34, 05-270 Marki, Polska
 Tel.: +48 22 435-82-44, Fax.: +48 22 427-52-66
 e-mail: FITOK@FITOKGROUP.PL